

REDISCOVER the Kentucky River

REDEFINE Frankfort

Come to Frankfort - catch a glimpse of our history and envision the possibilities of our future. Discover a city defined by its river.

The Kentucky River features a blend of natural places along the river that are within the City's four mile reach but look much the same way they looked when the frontiersmen paddled their way through Kentucky centuries ago.

Our Kentucky River, an emerald green ribbon that created the dramatic setting for both the Old State Capitol and our historic downtown, is once again stepping up to the plate as a catalyst for private development. We embrace the river to not only preserve centuries of heritage, but also to enhance the local and state economies for decades to come. There is a lot of new history in our future.

The enchantment of our frontier heritage and the graciousness of Kentucky hospitality make Frankfort a wonderful place to visit - for a day or a lifetime.

"We Kentuckians have taken something quite magnificent for granted for over 150 years, but that is not true today. Our greatest asset is ready to be discovered."

Judge Ted Collins

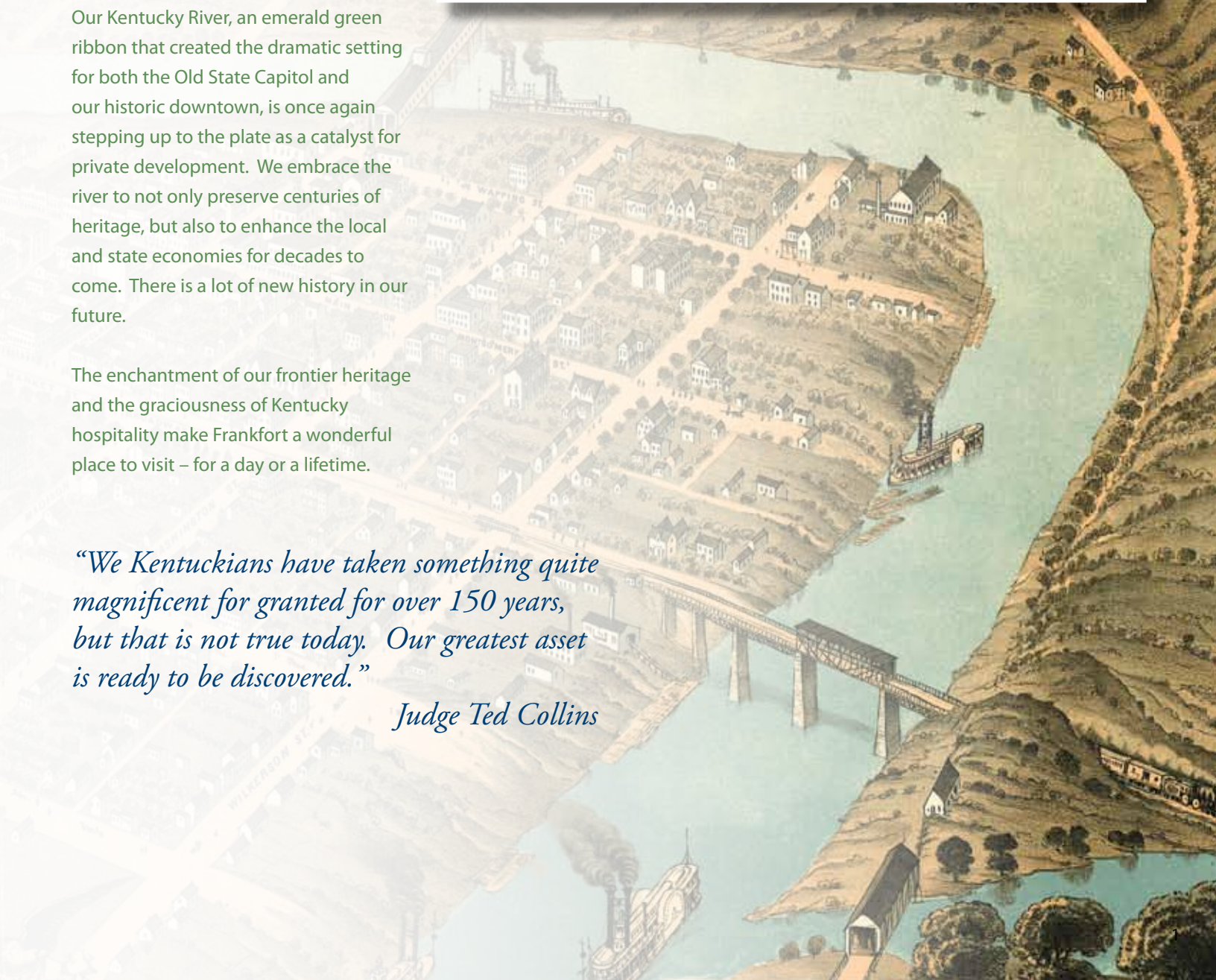



Our River *our home*

The Kentucky River will:

- ***become the centerpiece for revitalizing the entire Frankfort and Franklin County community and***
- ***help attract desirable development.***

Before the highway system, Frankfort was connected to the region through a system of maintained locks and dams. Once a working river, the Kentucky River provided transportation access from Frankfort to the Ohio River, connecting to far off locations like Cincinnati, St. Louis and beyond.

Frankfort's relationship with its river is changing. The potential for the City to rediscover the Kentucky River as a development, environmental and recreational resource is enormous. Many existing river-adjacent cultural and tourist destinations serve as the foundation for continued re-investment.

In 2007, the Commonwealth of Kentucky partnered with the Frankfort/Franklin County Tourist and Convention Commission to reconnect the community with its river through the preparation the Kentucky Riverfront Development Plan.

Join the **Momentum**

“This development of the riverfront has the support of our City, County, Kentucky State University, and the Commonwealth of Kentucky and we are poised to reconnect Kentuckians and visitors alike to our bounty along the Kentucky River.”

Mayor Gippy Graham

The Kentucky River Development Plan builds upon past success and envisions a redeveloped riverfront as the pride of Kentucky's Capital.

The plan sets forth a vision grounded in economic development, aesthetics and environmental stewardship for the next generation of private sector and community projects. It identifies private sector investment opportunities that increase the use of the riverfront and describe prime riverfront redevelopment parcels.

The City of Frankfort, Franklin County, the Commonwealth of Kentucky and the area business and civic community welcome the opportunity to meet with you and discuss your ideas for a more vibrant riverfront. We encourage you to contribute new ideas and new projects to help define the Kentucky River's future.





The goal of the Kentucky Riverfront Development Plan is to rediscover the river that runs through the heart of Frankfort. With rediscovery comes rewards:

- *improved quality of life for Frankfort and Franklin County residents,*
- *an increase in tourist activity and economic development, and*
- *the resulting increase in local tax revenue and employment.*

REDISCOVER Downtown

Downtown Frankfort is the center of the plan; all trails and roads lead to it. The Kentucky Riverwalk emanates from its heart and reaches out to the region.

REDISCOVER the Capitol

A panoramic and picturesque drive along the Capital Parkway reintroduces the Kentucky State Capitol to residents, students and visitors.

REDISCOVER History

Downtown and the riverfront are awash in cultural and historical resources. The Kentucky Riverwalk and interpretive signage tell Frankfort's rich and engaging story.

REDISCOVER Creativity

Art is infused throughout the river corridor, from restoring the river's historic crossings, an up-lighting installation on the quarry wall and artistic landforms along the Capital Parkway.

REDISCOVER Water, Health and Recreation

Residents and visitors can recreate on the water on rented canoes and water taxis/ tour boats. The seven-mile Kentucky Riverwalk will connect walkers and bikers with Capital View Park and its expanded adventure sports and camping.

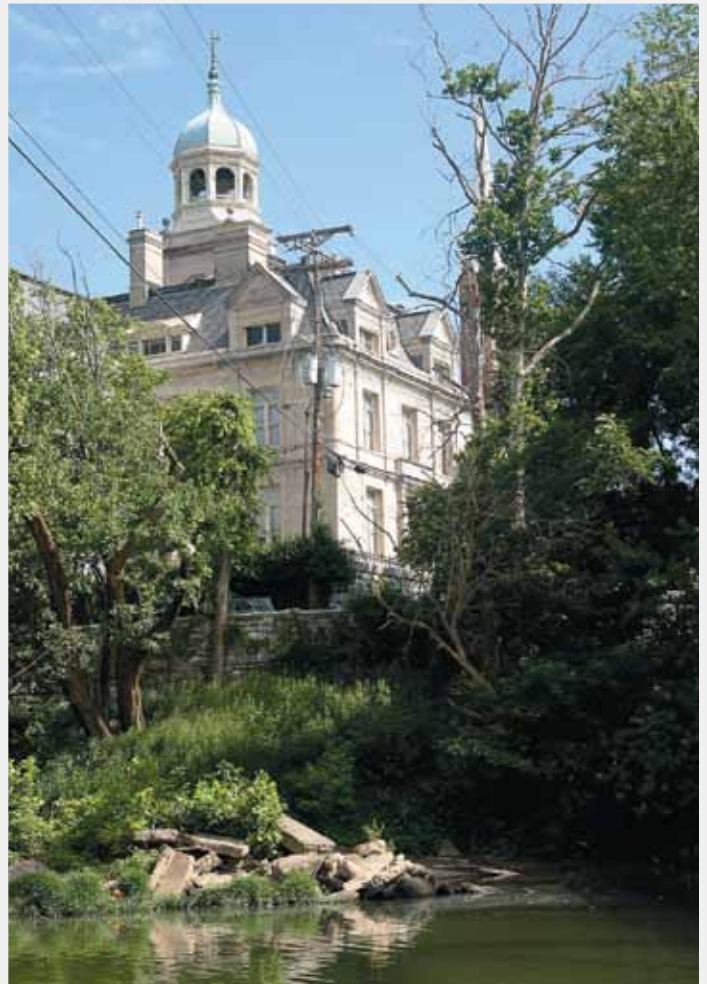

REDISCOVER the Environment

Kentucky State University's new downtown campus in the Old Federal Building will feature an environmental science education boat.

REDISCOVER Riverfront Investment & Communities

Mixed-use redevelopment at strategic riverfront locations will capitalize on the river's views and improve the local tax base. The renovated Lock and Dam 4 will initiate a reconnection of Frankfort to the Ohio River. Locally-focused mixed-use redevelopment and parks will bolster the livability of Bellepoint and South Frankfort.

REDISCOVER Fun

Residents and visitors gather at the river for festivals and celebrations at the amphitheater, a fountain or carousel in the new downtown urban park and new public marina and landing, making the river part of daily life.

“Students from across Kentucky will come to the environmental Discovery Center to learn about the fish in the Kentucky river, study the plant life, other facets of the river and perform experiments out on a boat especially designed for scientific research.”

When the boat is not in use with the students, it will be used by the Tourism Department for dinner cruises down the Kentucky River.”

*Dr. Mary Sias, President,
Kentucky State University*

REDISCOVERY: Kentucky Riverfront Development Plan

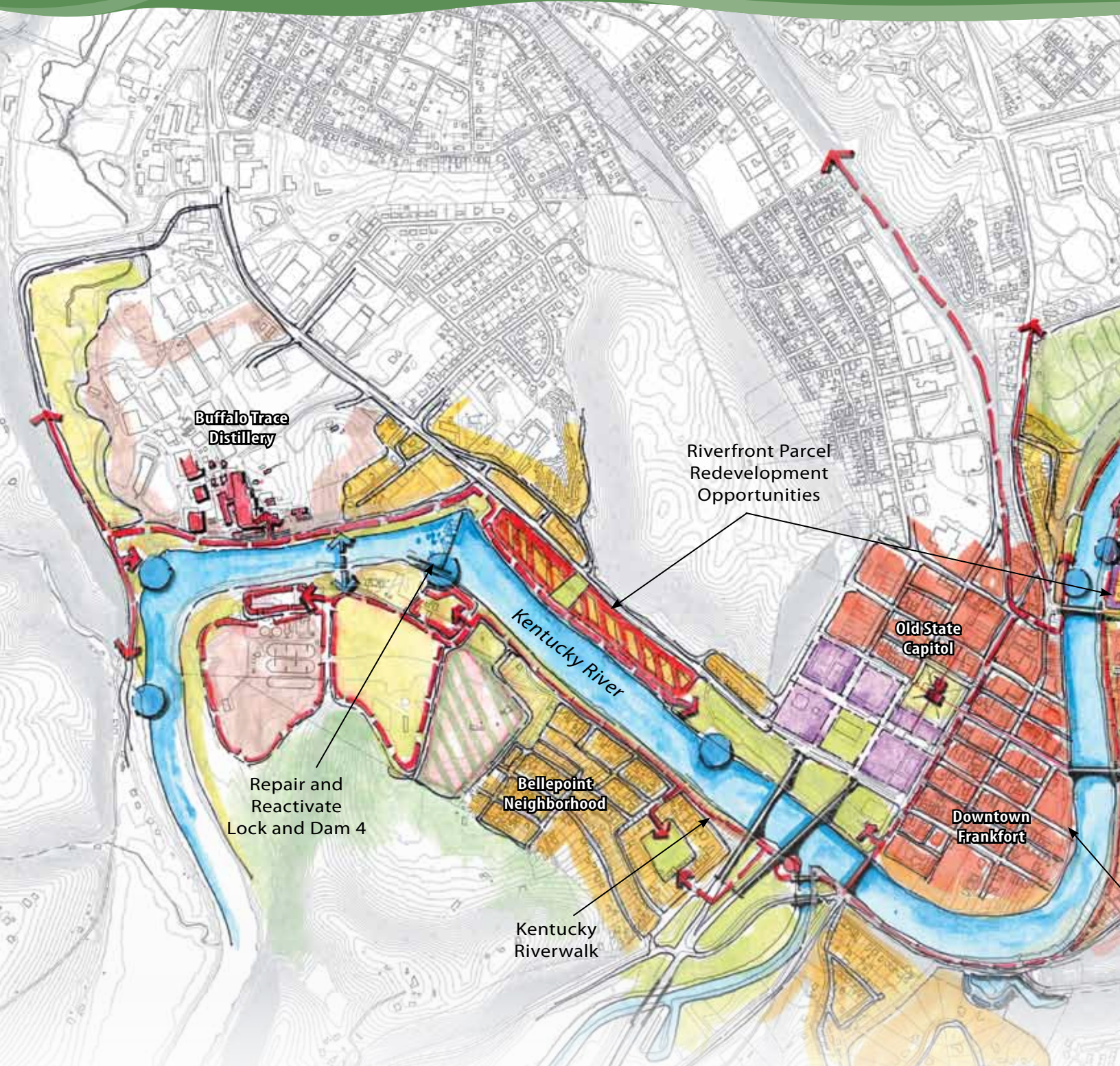

Leadership by local and state government to actively support Frankfort redevelopment and revitalization

Plentiful heritage tourism resources

Opportunities to partner with Kentucky State University and Buffalo Trace Distillery

Target residents, commuters and tourists

Infrastructure improvement grants

Public access to 85% of the riverfront

Regional trails and neighborhood connections

Trends in healthier lifestyles

Environmental stewardship

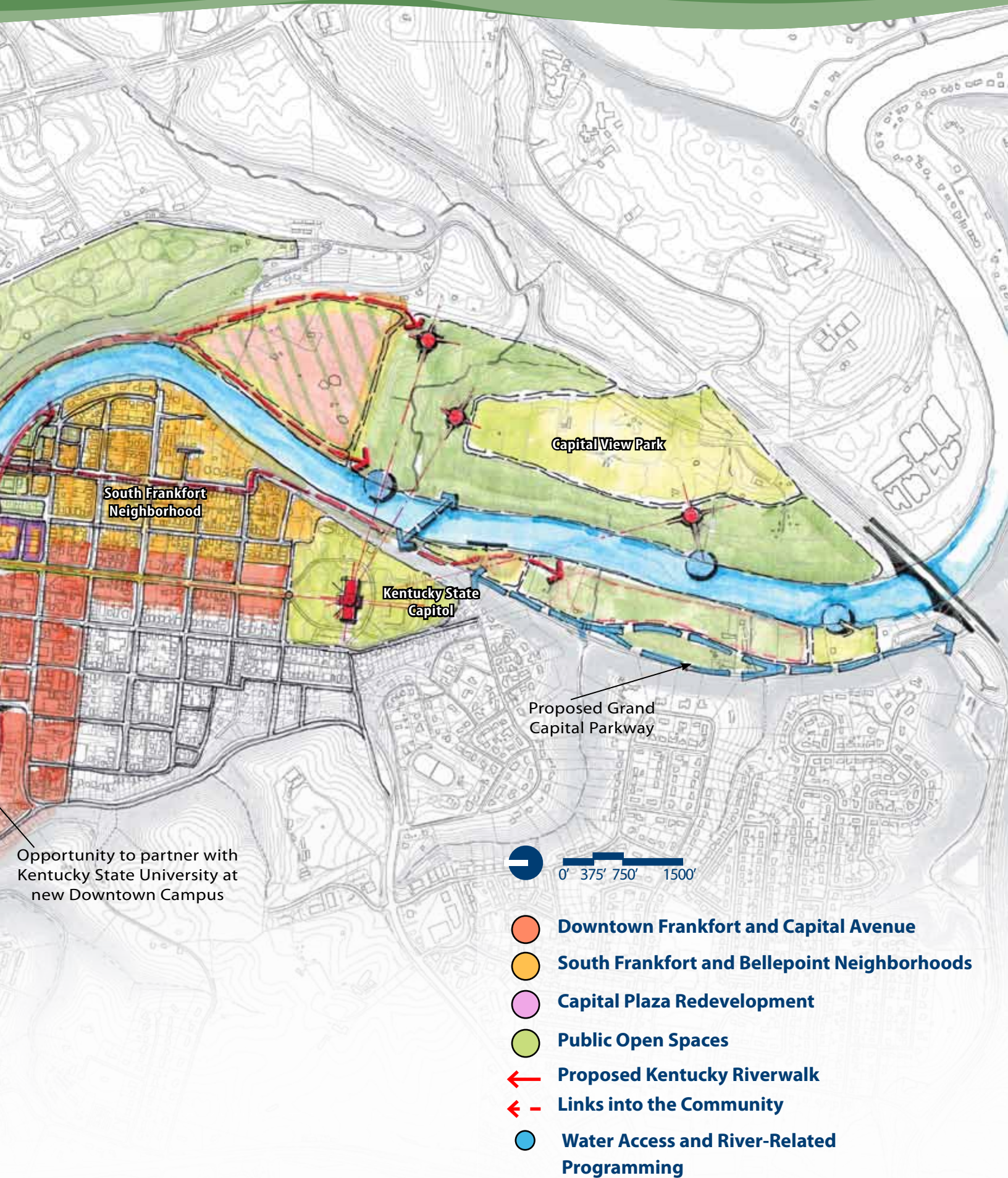

Opportunity to partner with Kentucky State University at new Downtown Campus



-  **Downtown Frankfort and Capital Avenue**
-  **South Frankfort and Bellepoint Neighborhoods**
-  **Capital Plaza Redevelopment**
-  **Public Open Spaces**
-  **Proposed Kentucky Riverwalk**
-  **Links into the Community**
-  **Water Access and River-Related Programming**

RIVERFRONT REDEVELOPMENT PRIORITIES



REDEVELOP: Capital Avenue at the River

The former Frankfort Lumber site, combined with adjacent parcels, can become a significant riverfront mixed-use infill development.

The Kentucky Riverwalk will directly connect the redevelopment site with Downtown Frankfort and surrounding riverfront cultural and historic resources.

The former Frankfort Lumber site and adjacent parcels should be redeveloped as riverfront residential with supportive retail. Redevelopment should protect and expand Rebecca Ruth Candies.



Riverfront residential redevelopment opportunity with new dock.

New and expanded South Frankfort neighborhood parks could feature community gardens and a dog park. A new public landing on the north shore will get downtown residents, workers and tourists on the water.



A northside public marina can host transient slips, a tour boat stop and seasonal vendors.

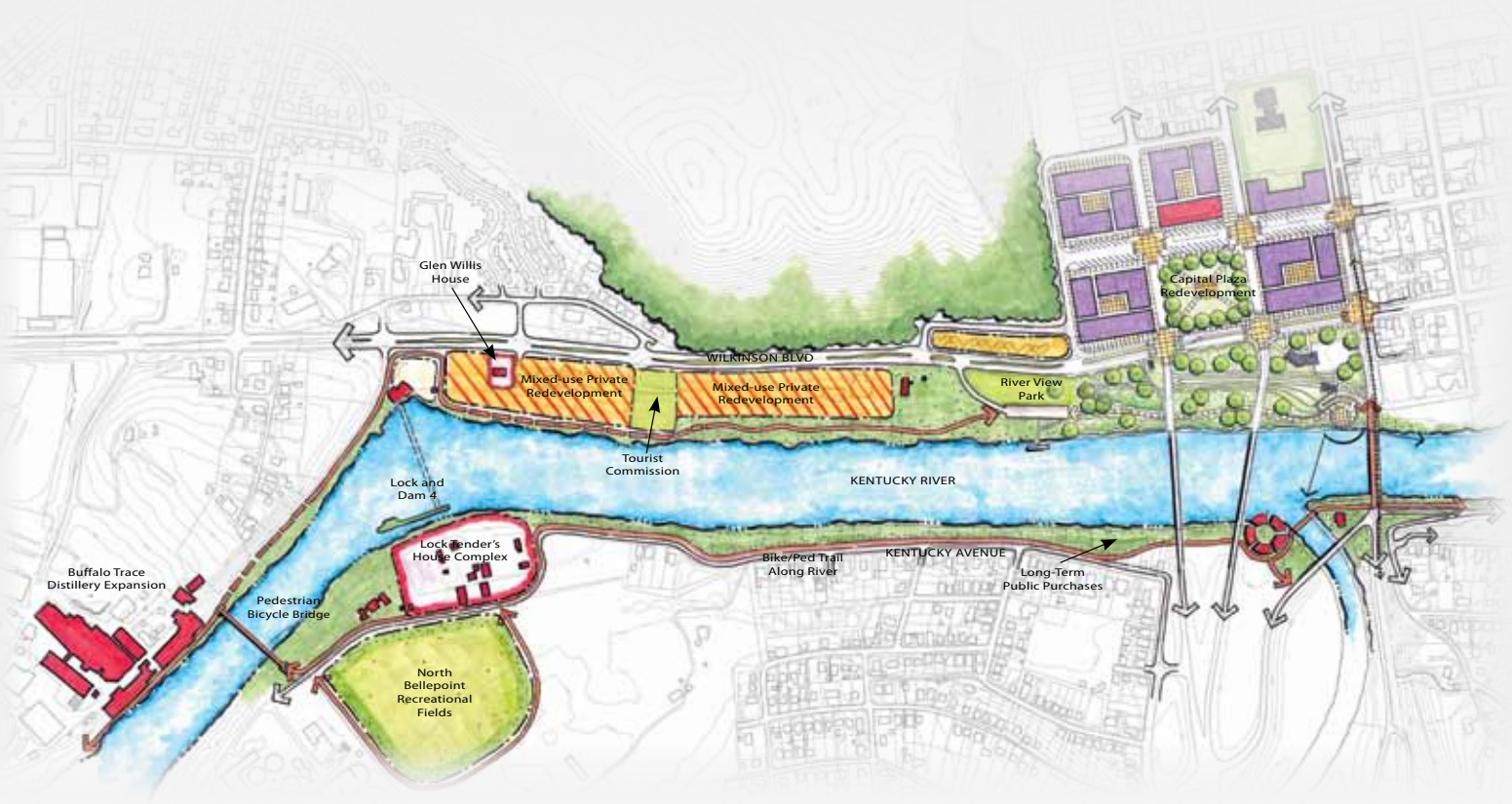

REDEVELOP : Wilkinson Boulevard Riverfront

Riverfront parcels along Wilkinson Boulevard north of Downtown should be residential, office or a mix of these uses.

The historic Glen Willis House should be preserved and integrated into the riverfront redevelopment.

The Kentucky Riverwalk will connect Downtown with Buffalo Trace Distillery. A new midpoint riverfront park will be one of a series of destinations along the Kentucky Riverwalk.

REDEVELOP : River View Park and Capital Plaza

A proposed amphitheater against the floodwall and more programming will support a more vibrant River View Park.

A new central gathering space in the redeveloped Capital Plaza Complex will draw the riverfront into the downtown.



Proposed improvements to River View Park and Capital Plaza Complex

RIVERFRONT ACCESS PRIORITIES



Expand Capital View Park's mission to include environment-focused recreation and education.

A park boat dock will connect the park via an environmental science barge to other educational sites.

Multiple sites offer an opportunity for an interpretation center and expanded recreational uses.

Multimodal trails should connect tourists, residents and employees in downtown and South Frankfort to Capital View Park.

A pedestrian bridge should connect Capital View Park to the Capitol, linking educational opportunities and the regional trail network.

EXPAND: Capital View Park

CONSTRUCT: New Capital Parkway

Old Lawrenceburg Road should be transformed into Capital Parkway, a civic grand entrance to the State Capitol Complex.



A multi-use trail and traditional dry stone walls characterize the Capital Parkway. The median creates opportunities for seasonal plantings from the native Kentucky landscape.

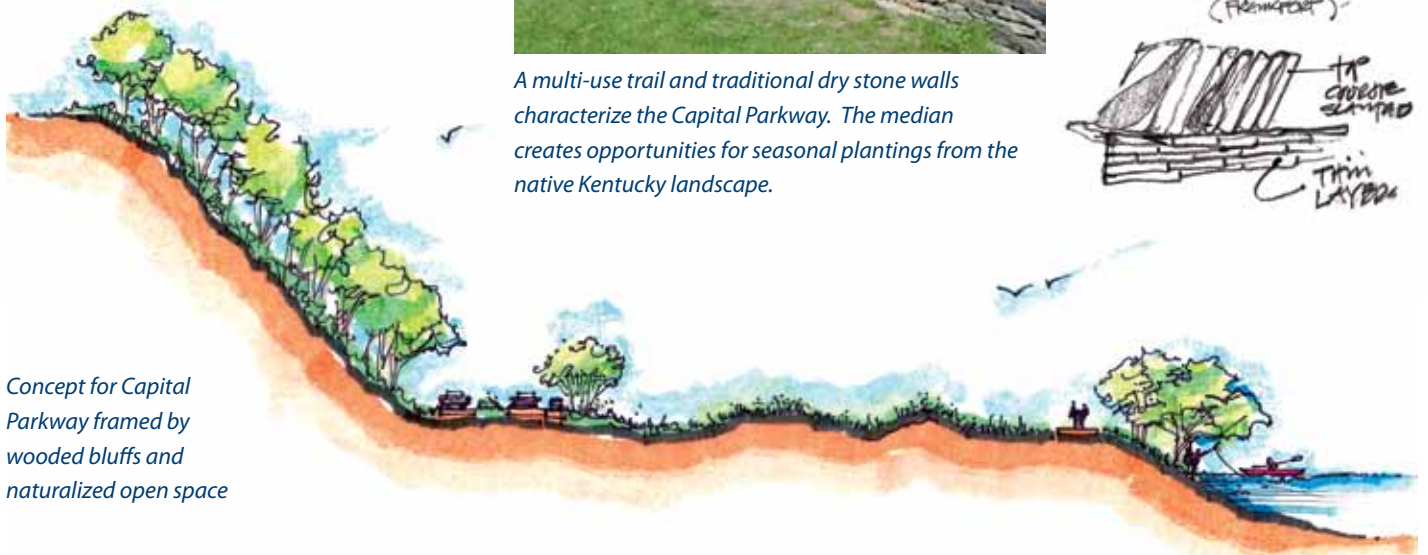
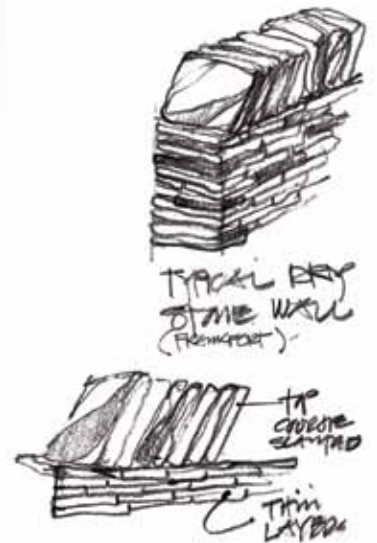

Concept for Capital Parkway framed by wooded bluffs and naturalized open space

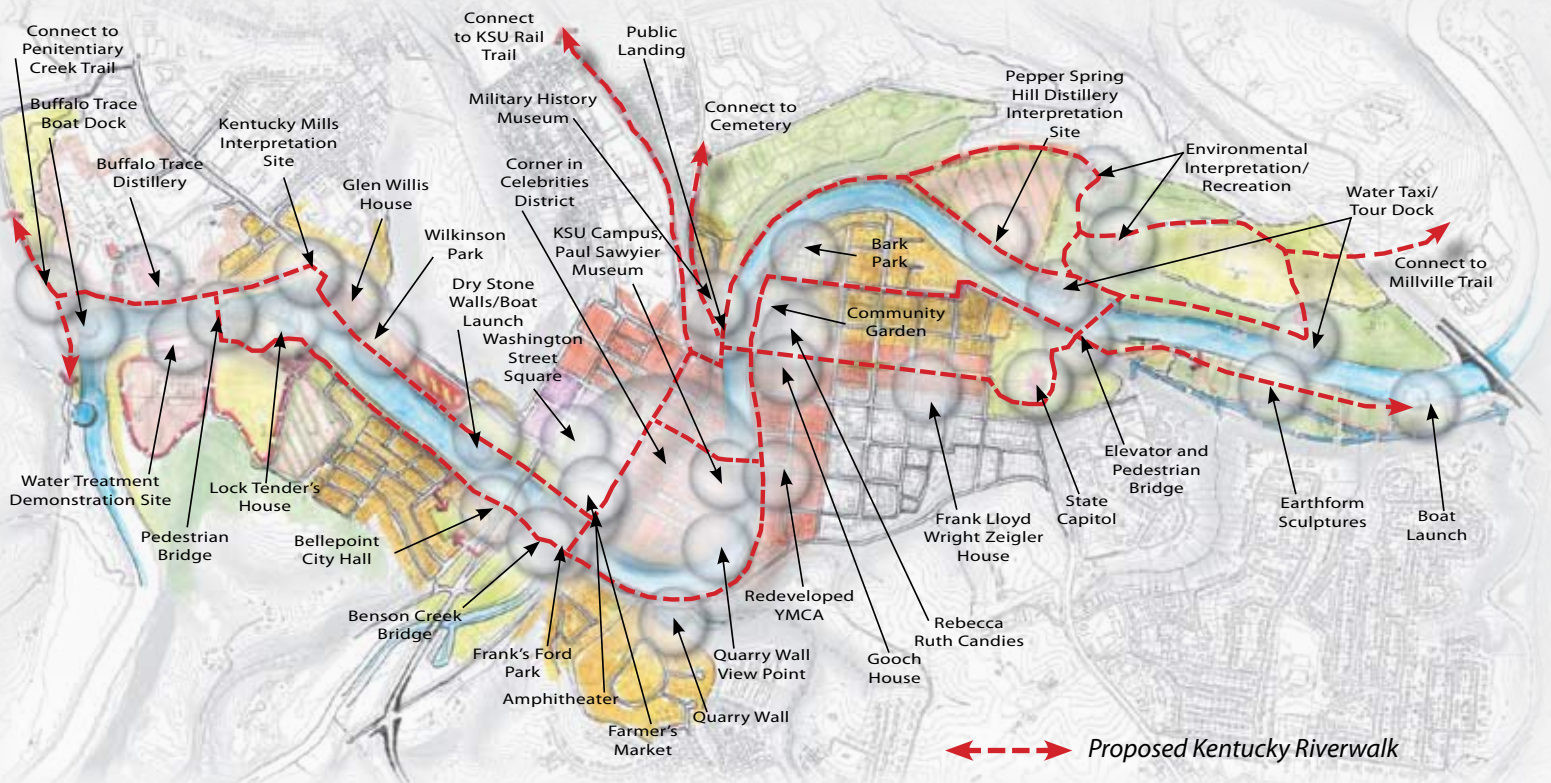

LINK: Kentucky Riverwalk

The Kentucky Riverwalk will tie together the City's impressive cultural resources while highlighting Kentucky's natural beauty and the river.

The seven-mile loop extends from Buffalo Trace Distillery to Capital View Park on both banks of the river.

Frankfort residents and visitors must visually connect with the river, and river users must visually connect with the City.

Well-publicized and connected network of transient slips is necessary to support water transportation and touring.

Those without their own boat can access the water through canoe/kayak rental, water taxi and tour boat.



“Frankfort has the opportunity to tie together many of its cultural, historical, and natural landmarks through the creation of an innovative riverwalk that will bring visitors back year after year.”
First Lady Jane Beshear

Acknowledgements

This riverfront development plan is the culmination of the efforts of many individuals and groups who devoted their time and energy to the future of the Frankfort riverfront. We extend our sincere appreciation to everyone who made this plan possible through their enthusiasm, commitment, creative input and financial support.

A very special thanks is owed to the following individuals for their leadership throughout the planning process:

Riverfront Development Committee

Rodney Simpson, Co-Chair

Joy Jeffries, Co-Chair

Commissioner Kathy Carter

Todd Cassidy

Judge Executive Ted Collins

Ed Council

Dr. Kimberly Holmes

Mayor Gippy Graham

Jerry Graves

Leslie Isaacs

Magistrate Phillip Kring

Glenn Mitchell

The redevelopment plan study was made possible through financial support provided by the Commonwealth of Kentucky.

Images used by permission: JJR, Gene Burch, Bob Lanham

Plan prepared by:
JJR, LLC • 625 Williamson Street • Madison, Wisconsin
(608) 251-1177
www.jjr-us.com